

12PKW-162016: T-grandi Blanc 16x20x16

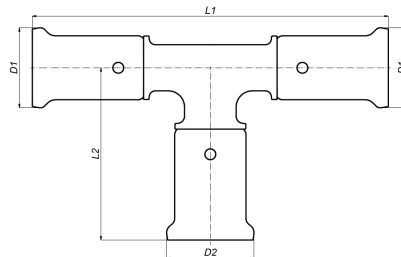

Informations commerciales

PVDF press fittings in combination with multilayer pipe, a completely corrosion-free system. The synthetic press fittings are made from injection moulded PVDF (Polyvinylidene fluoride)*. PVDF offers the user a unique combination of properties:

- Highly resistant to pressure and temperature
- Excellent mechanical strength
- Extreme flexibility: bending up to 10° is possible
- Perfectly suited for drinking water and food
- Highly resistant to chemicals and corrosion
- Embedding is possible without extra protection

Certificats

STF,QB (CSTBat),SINTEF,ATG,ETA,AFNOR,ACS,RISE,DVGW Wasser,Aenor,Sans 21003

Applications

drinkwater,verwarming,perslucht,koeling,demi water

Solutions

gebouwinstallaties,industrie

Caractéristiques techniques

Material connection 1	Polyvinylidene fluoride (PVDF)	Angle	90 Degrees
Surface protection connection 1	Untreated	Angle	90 90 Degrees
Surface treatment connection 1	Untreated	Outer pipe diameter connection 1	16 Millimetre
Material connection 2	Polyvinylidene fluoride (PVDF)	Wall thickness, connection 1	0,7 Millimetre
Surface protection connection 2	Untreated	Outer pipe diameter connection 2	20 Millimetre
Surface treatment connection 2	Untreated	Wall thickness, connection 2	0,7 Millimetre
Material connection 3	Polyvinylidene fluoride (PVDF)	Outer pipe diameter connection 3	16 Millimetre
Surface protection connection 3	Untreated	Wall thickness, connection 3	0,7 Millimetre
Surface treatment connection 3	Untreated	Length of connection 1	50 Millimetre
Model	T-piece	Working length connection 1	23 Millimetre
Angle adjustable	No	Length of connection 2	48 Millimetre
Swept entry type (with inner radius)	No	Working length connection 2	21 Millimetre
Reducing	Yes	Length of connection 3	50 Millimetre
Multi-part	No	Working length connection 3	23 Millimetre
System-specific	Yes	Min. medium temperature (continuous)	-10 Degrees celsius
Nominal diameter connection 1	DN 8	Max. medium temperature (continuous)	70 Degrees celsius
Connection 1	Press sleeve	Wrench width union nut	0 Millimetre
Contour code connection 1	TH	Max. operating pressure at 20 °C	16 Pressure
Nominal diameter connection 2	DN 10	Standard Dimension Ratio (SDR)	0
Connection 2	Press sleeve		
Contour code connection 2	TH		
Nominal diameter connection 3	DN 8		
Connection 3	Press sleeve		
Contour code	TH		
Contour code connection 3	TH		
Flange standard	Other		
Material sealing	Ethylene-propylene diene monomer rubber (EPDM)		
Main colour fitting	White		
High tensile strength	No		
Ring stiffness class	Other		
With sealing rings/gaskets	Yes		
With drain	No		
Gastec QA	No		
KIWA certified	No		
With buffer stud	No		
Capped	No		
FM quality mark	No		
LPCB quality mark	No		
VdS quality mark	No		
ULC quality mark	No		
UL quality mark	No		

Produits liés

12PKW-202620: T-grandi Blanc 20x26x20

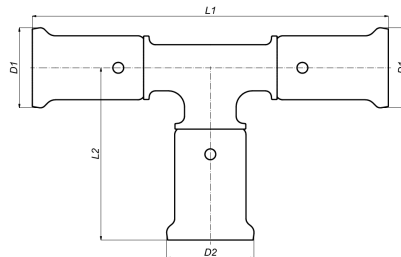

Informations commerciales

PVDF press fittings in combination with multilayer pipe, a completely corrosion-free system. The synthetic press fittings are made from injection moulded PVDF (Polyvinylidene fluoride)*. PVDF offers the user a unique combination of properties:

- Highly resistant to pressure and temperature
- Excellent mechanical strength
- Extreme flexibility: bending up to 10° is possible
- Perfectly suited for drinking water and food
- Highly resistant to chemicals and corrosion
- Embedding is possible without extra protection

Certificats

STF,QB (CSTBat),SINTEF,ATG,ETA,AFNOR,ACS,RISE,DVGW Wasser,Aenor,Sans 21003

Applications

drinkwater,verwarming,perslucht,koeling,demi water

Solutions

gebouwinstallaties,industrie

Caractéristiques techniques

Material connection 1	Polyvinylidene fluoride (PVDF)	Angle	90 Degrees
Surface protection connection 1	Untreated	Angle	90 90 Degrees
Surface treatment connection 1	Untreated	Outer pipe diameter connection 1	20 Millimetre
Material connection 2	Polyvinylidene fluoride (PVDF)	Wall thickness, connection 1	0,7 Millimetre
Surface protection connection 2	Untreated	Outer pipe diameter connection 2	26 Millimetre
Surface treatment connection 2	Untreated	Wall thickness, connection 2	1 Millimetre
Material connection 3	Polyvinylidene fluoride (PVDF)	Outer pipe diameter connection 3	20 Millimetre
Surface protection connection 3	Untreated	Wall thickness, connection 3	0,7 Millimetre
Surface treatment connection 3	Untreated	Length of connection 1	53,5 Millimetre
Model	T-piece	Working length connection 1	26,5 Millimetre
Angle adjustable	No	Length of connection 2	51,5 Millimetre
Swept entry type (with inner radius)	No	Working length connection 2	24,5 Millimetre
Reducing	Yes	Length of connection 3	53,5 Millimetre
Multi-part	No	Working length connection 3	26,5 Millimetre
System-specific	Yes	Min. medium temperature (continuous)	-10 Degrees celsius
Nominal diameter connection 1	DN 10	Max. medium temperature (continuous)	70 Degrees celsius
Connection 1	Press sleeve	Wrench width union nut	0 Millimetre
Contour code connection 1	TH	Max. operating pressure at 20 °C	16 Pressure
Nominal diameter connection 2	DN 15	Standard Dimension Ratio (SDR)	0
Connection 2	Press sleeve		
Contour code connection 2	TH		
Nominal diameter connection 3	DN 10		
Connection 3	Press sleeve		
Contour code	TH		
Contour code connection 3	TH		
Flange standard	Other		
Material sealing	Ethylene-propylene diene monomer rubber (EPDM)		
Main colour fitting	White		
High tensile strength	No		
Ring stiffness class	Other		
With sealing rings/gaskets	Yes		
With drain	No		
Gastec QA	No		
KIWA certified	No		
With buffer stud	No		
Capped	No		
FM quality mark	No		
LPCB quality mark	No		
VdS quality mark	No		
ULC quality mark	No		
UL quality mark	No		

Produits liés

12PKW-263226: T-grandi Blanc 26x32x26

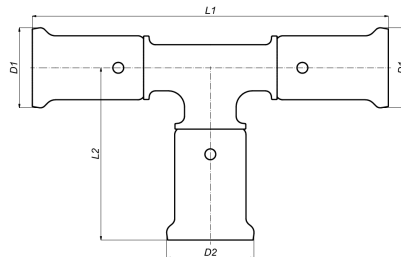

Informations commerciales

PVDF press fittings in combination with multilayer pipe, a completely corrosion-free system. The synthetic press fittings are made from injection moulded PVDF (Polyvinylidene fluoride)*. PVDF offers the user a unique combination of properties:

- Highly resistant to pressure and temperature
- Excellent mechanical strength
- Extreme flexibility: bending up to 10° is possible
- Perfectly suited for drinking water and food
- Highly resistant to chemicals and corrosion
- Embedding is possible without extra protection

Certificats

ATG,ETA,SINTEF,STF,QB (CSTBat),AFNOR,ACS,RISE,DVGW Wasser,Aenor,Sans 21003

Applications

drinkwater, verwarming, koeling, perslucht

Solutions

gebouwinstallaties, industrie

Caractéristiques techniques

Material connection 1	Polyvinylidene fluoride (PVDF)	Angle	90 90 Degrees
Material connection 2	Polyvinylidene fluoride (PVDF)	Outer pipe diameter connection 1	26 Millimetre
Material connection 3	Polyvinylidene fluoride (PVDF)	Wall thickness, connection 1	1 Millimetre
Angle adjustable	No	Outer pipe diameter connection 2	32 Millimetre
Swept entry type (with inner radius)	No	Wall thickness, connection 2	0,9 Millimetre
Reducing	Yes	Outer pipe diameter connection 3	26 Millimetre
Multi-part	No	Wall thickness, connection 3	1 Millimetre
System-specific	Yes	Working length connection 1	30 Millimetre
Nominal diameter connection 1	DN 15	Min. medium temperature (continuous)	-10 Degrees celsius
Connection 1	Press sleeve	Max. medium temperature (continuous)	70 Degrees celsius
Contour code connection 1	BE	Max. operating pressure at 20 °C	10 Pressure
Connection 2	Press sleeve	Standard Dimension Ratio (SDR)	0
Contour code connection 2	BE		
Nominal diameter connection 3	DN 15		
Connection 3	Press sleeve		
Contour code	BE		
Contour code connection 3	TH		
Flange standard	Other		
Material sealing	Ethylene-propylene diene monomer rubber (EPDM)		
Main colour fitting	White		
High tensile strength	No		
Ring stiffness class	Other		
With sealing rings/gaskets	Yes		
With drain	No		
Gastec QA	No		
KIWA certified	No		
With buffer stud	No		
Capped	No		
FM quality mark	No		
LPCB quality mark	No		
VdS quality mark	No		
ULC quality mark	No		
UL quality mark	No		

Produits liés